

TWO-STAGE OIL LUBRICATED ROTARY VANE

VCD Series



V A K U U M E X P E R T E N



VACUUM

Ingersoll Rand

Ingersoll Rand Inc. (NYSE:IR), driven by an entrepreneurial spirit and ownership mindset, is dedicated to Making Life Better for our employees, customers, shareholders, and planet. Customers lean on us for exceptional performance and durability in mission-critical flow creation and industrial solutions. Supported by over 80+ respected brands, our products and services excel in very complex and harsh conditions. Our employees develop customers for life through their daily commitment to expertise, productivity, and efficiency. For more information, visit www.IRCO.com.

Ingersoll Rand's brands include Ingersoll Rand, Gardner Denver, Elmo Rietschle, Robuschi and dozens of other well-known enterprises in the field of air compressors, blowers and vacuum pumps.

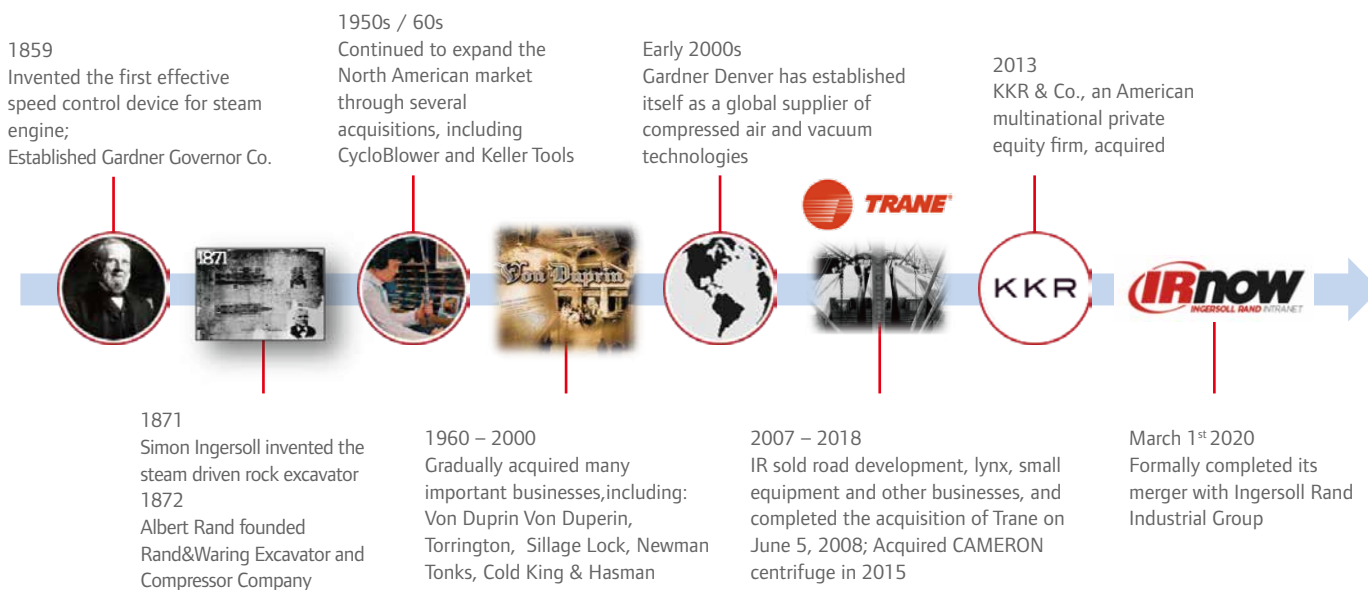

Elmo Rietschle

Elmo was granted the imperial patent for the world's first liquid ring vacuum pump: just three years later a smaller Elmo vacuum pump was used in Germany's first vacuum cleaner

The first side channel blower was introduced in 1963 and greatly revolutionized the vacuum and pressure market. Elmo had always been focusing on professionalism and dedication, as it designed and manufactured the highest-quality machine and provide engineering support

After splitting from Siemens. Elmo joined Nash Inc. to form Nash Elmo



In 2006, Gardner Denver acquired Elmo and Rietschle to launch the Elmo Rietschle brand name



Formally completed merger with Ingersoll Rand Industrial Group

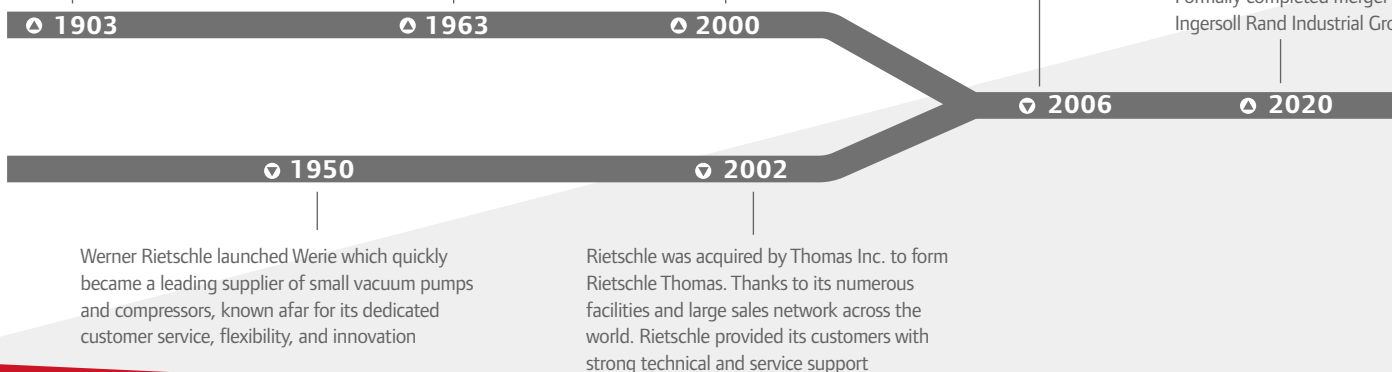



OIL LUBRICATED



VACUUM

Industry Application

The two-stage oil lubricated rotary vane vacuum pump is a device widely used in scientific research, industry, and medical fields, mainly for generating high vacuum environments to meet various testing and production needs.

It can be used as an independent vacuum pump and can also be used in conjunction with booster pumps, diffusion pumps, and molecular pumps.

Typical Application

- **Scientific research laboratory:** used for experiments that require precise control of the vacuum environment, such as chemical reactions, material testing, etc
- **Industrial production:** vacuum coating, vacuum drying, vacuum impregnation, etc
- **Medical equipment:** glove box, nuclear magnetic resonance equipment, etc
- **Environmental engineering:** gas purification and recovery system
- **Food packaging:** vacuum packaging process
- **Other fields:** semiconductor manufacturing, lighting equipment production, aerospace, etc



Coating



High-precision Instruments



Refrigeration and Air Conditioning



Laboratory



Glovebox



Drying Ovens

VCD Series Two-stage Oil Lubricated Rotary Vane

Modern vacuum engineering applications place increasingly stringent demands on the vacuum pumps and components used. Elmo Rietschle meets these increasing demands with vacuum solutions, components and complete systems. As a brand with many years of experience in the development and manufacture of oil-filled rotary vane vacuum pumps, Elmo Rietschle is known for innovative products with excellent design, outstanding reliability and environmental compatibility. VCD series two-stage oil lubricated rotary vane vacuum pump has been newly developed by Elmo Rietschle, which is designed for a wide range of vacuum applications.

Feature Overview

- Reliable quality and stable operation
- Forced lubrication, excellent performance
- Multi-stage air ballast, adjustable as needed
- Tight sealing to prevent oil return
- Low noise and vibration, safe to use
- Simple structure and easy maintenance

High Reliability One-way Valve

It has the characteristics of high strength and good toughness, and the valve can be opened and closed flexibly and sealed reliably, which can effectively prevent the oil return phenomenon during the suction process of the pump

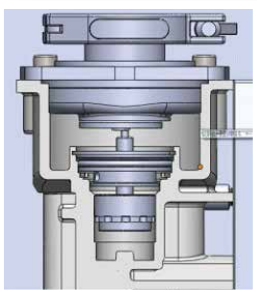

KF International Standard
Vacuum Flange

Ballast Valve with
Three-position Control

Three-position Adjustable Ballast Valve

Unlike the two-position adjustment commonly found in the market, VCD series adopts three-position adjustment, which allows users to better adjust the compression ratio of the compression chamber according to different working conditions, and makes the pump more efficient in removing gas.

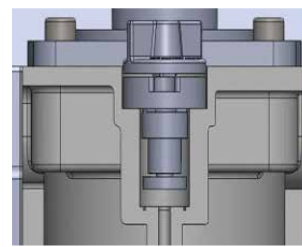

High Efficiency Motor
with Low Noise

Enhanced Heat
Dissipation Rear Wing

Self-contained Fan to
Cool the Pump (VCD275
is water-cooled)





OIL LUBRICATED



VACUUM

Technical Parameters

Model		VCD6	VCD12	VCD22	VCD32	VCD50	VCD60	VCD80	VCD275
Pumping Speed (m ³ /h)		5.6	11.5	20.2	31.2	47.1	59.5	78.0	255
Ultimate Vacuum (mbar)	Gas ballast	4 x 10 ⁻³							
Oil-filling Volume (L)		1.3	1.5	2.0	2.3	3.7	4.0	4.5	30
Inlet Dia DN (mm)		25				40			ISO63
Outlet Dia DN (mm)		25				40			ISO63
Motor Rating (kW)		0.55	0.55	0.75	1.1	1.5	2.2	3.0	7.5
Speed 50Hz (rpm)		1420							
Noise (dB(A))		49	49	51	51	55	55	55	75
Weightm (kg) (Excl. Oil)		23	25	32	33	56	68	75.5	254

VCD6-80 Performance Curve

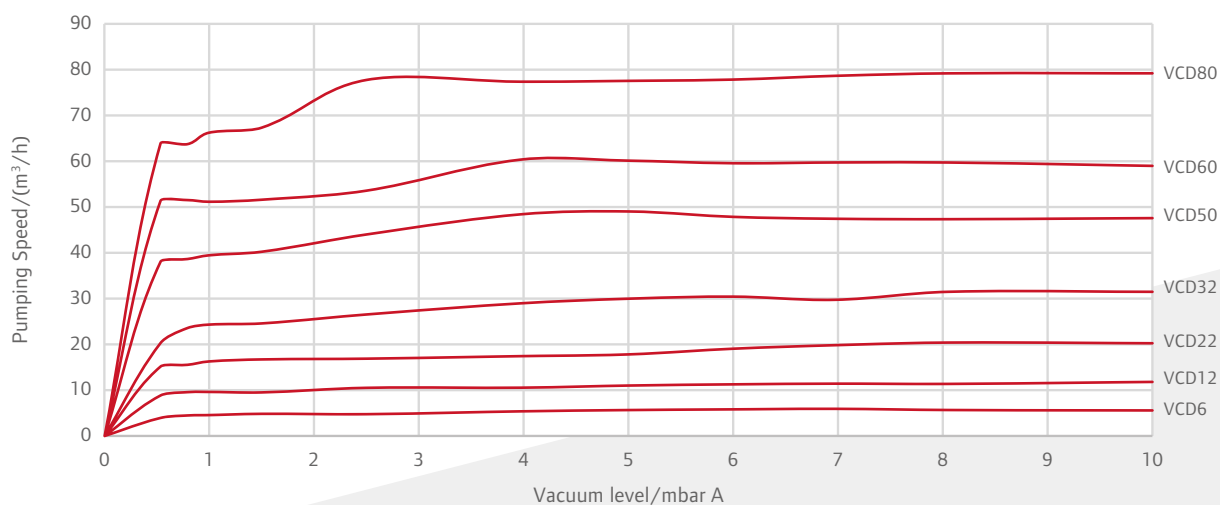

VCD275 Performance Curve

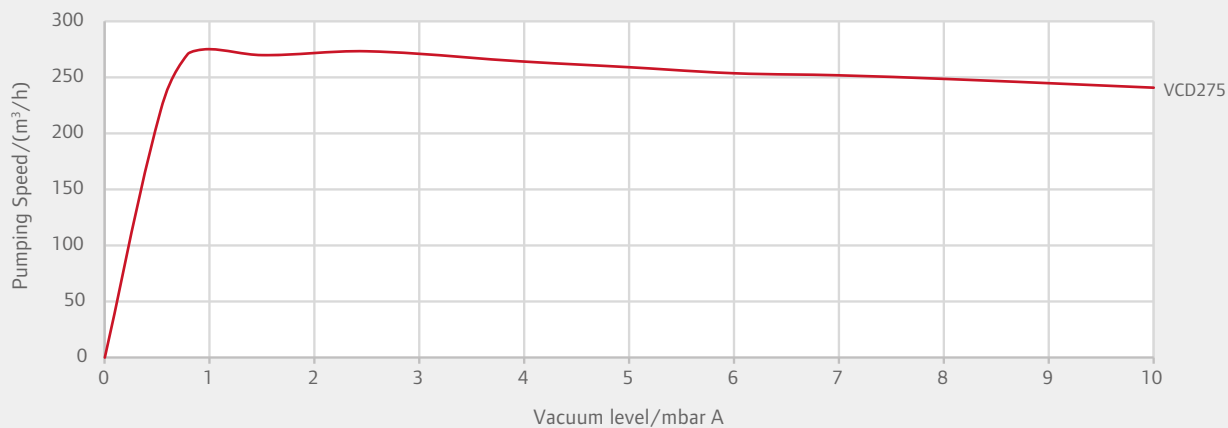

Dimensions

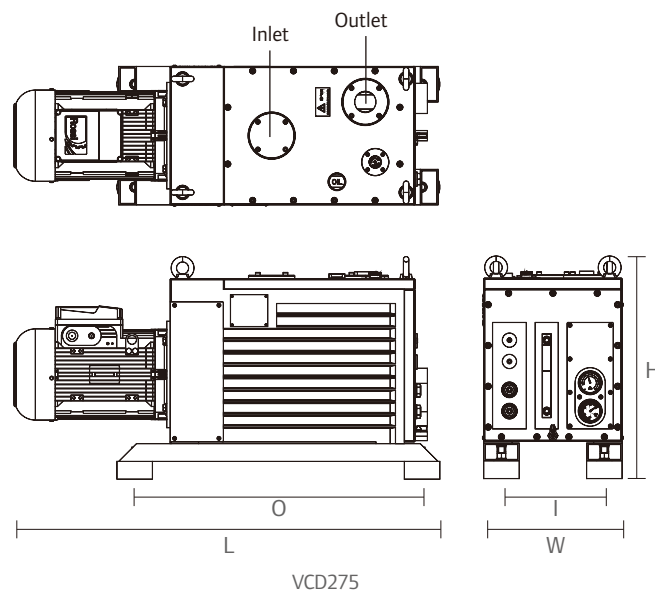
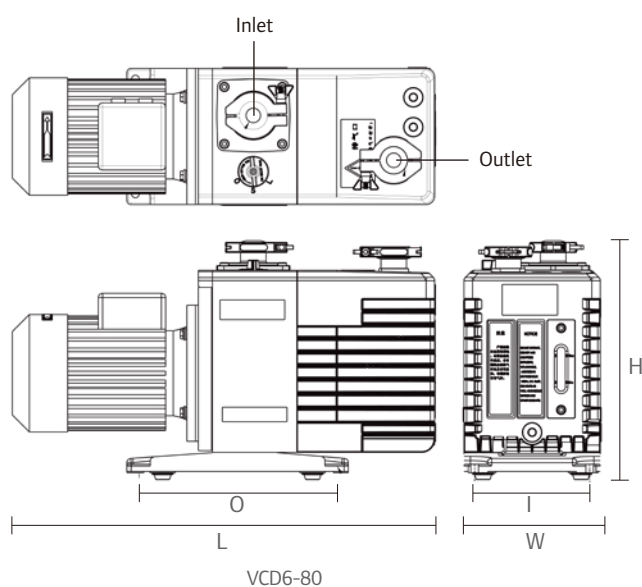

Model	L(mm)	W(mm)	H(mm)	O(mm)	I(mm)	Footwell
VCD6	480	160	276	240	135	φ 9
VCD12	510	160	276	240	135	φ 9
VCD22	570	200	330	297	160	φ 12
VCD32	600	200	330	297	160	φ 12
VCD50	720	250	390	550	190	φ 14
VCD60	740	250	390	550	190	φ 14
VCD80	780	250	390	550	190	φ 14
VCD275	1200	390	627	810	290	/

* Motor is included in the above dimensions.





OIL LUBRICATED



VACUUM

VCD with...

Booster

Paired with the Ingersoll-Rand booster pump, the VCD has a higher pumping speed and a higher ultimate vacuum capability.

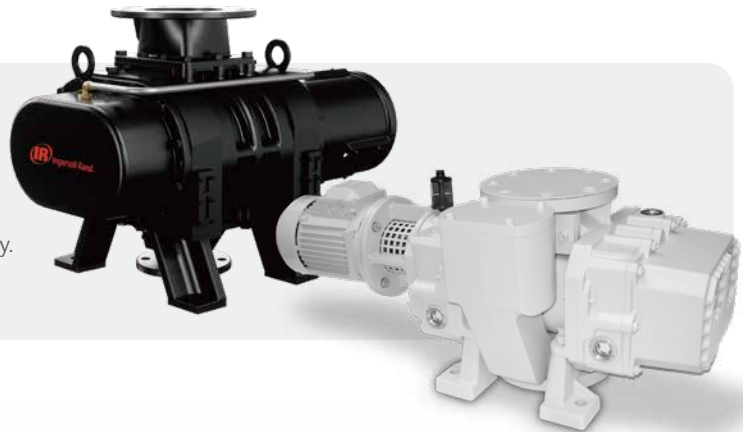

Oil Lubricated Rotary Vane + Booster

Using a single-stage rotary vane pump + booster pump combination as the front pump, VCD can be used as a vacuum maintenance pump to operate in a more energy-efficient and efficient mode.



After-sales Service

We Keep An Eye on every machine in use

We Pay Great Attention to the user experience of every customer

We Care About the customers return on investment of every plant

Ingersoll Rand provides comprehensive after-sales services, including but not limited to preventative & scheduled maintenance program, genuine parts, onsite inspection, expert maintenance, customer visits and effective professional training, just to make sure that every product runs well at optimal performance for your peace of mind.



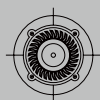

G-Series Side Channel



L-Series Liquid Ring



V-Series Rotary Vane

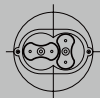

R-Series Roots



C-Series Claw

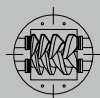

S-Series Screw

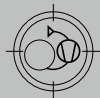

X-Series Syetems

www.elmorietschle.com

For SE Asia region, please contact
sales.sg@irco.com

For Australia, please contact
sales.au@irco.com